

## Mini Screw Screens WASTEMASTER CT - CTC



## THE LIGHTEST SCREW SCREEN

The WASTEMASTER CT Screw Screen consists of a tubular screen equipped with a screw in SINT® engineering polymer. WASTEMASTER CT is an inclined screw screen suitable for small flow rates in pit application. Due to its steep installation angle the WASTEMASTER CT Mini-Screw Screen can be fitted in small pits or in any application in which very low flow rates of waste water have to be handled. Examples are small industrial applications, hotels, resorts, car washes, etc.

An interesting application is for mechanical pre-treatment in small container waste water plants, via direct feeding through a submersible pump or directly flanged to the sewage pipe. Generally WASTEMASTER CT Mini-Screw Screen is suitable for applications with low flow rates in confined spaces.



WASTEMASTER CT  
installed on small pit



WASTEMASTER CTC  
installed on tank

### Overall Dimensions

#### CT

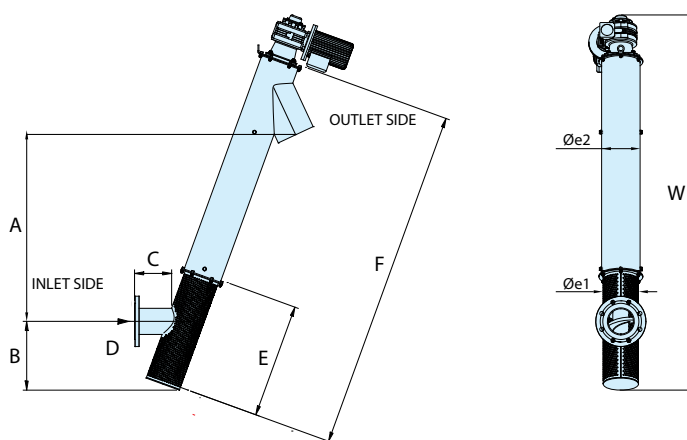

MOD.	A	B	C	D	E	F	W	Øe1	Øe2
CT 150	815	300	162	110	500	1,500	1,638	156	168
CT 200	1,040	368	147	160	625	1,868	1,993	219	206

#### CTC

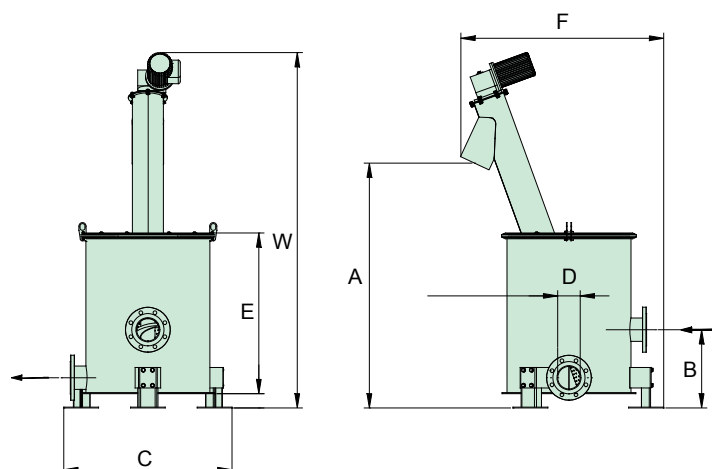

MOD.	A	B	C	D	E	F	W	Øe1	Øe2
CTC 150	1,200	385	825	DN 100	785	995	1,740	168	156
CTC 200	1,490	450	1,000	DN 150	938	1,360	2,074	206	268

Dimensions in mm

## Benefits

- ✓ **Lightweight design;**
- ✓ **High extraction efficiency;**
- ✓ **No brushes;**
- ✓ **Easy installation;**
- ✓ **No internal bearings;**
- ✓ **Low investment and maintenance costs.**

## Technical Features

- All fabricated parts in 304L / 316L stainless steel
- Anti-wear SINT® engineering polymer screw
- Screens in different mesh sizes (2 or 5 mm)
- For municipal and industrial solids-liquid separation of effluents



Gear Motor



Outlet Spout

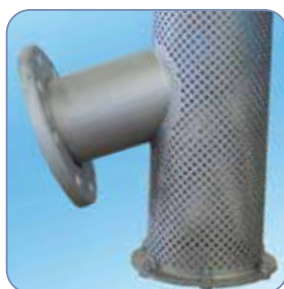

Inlet spout and screen basket

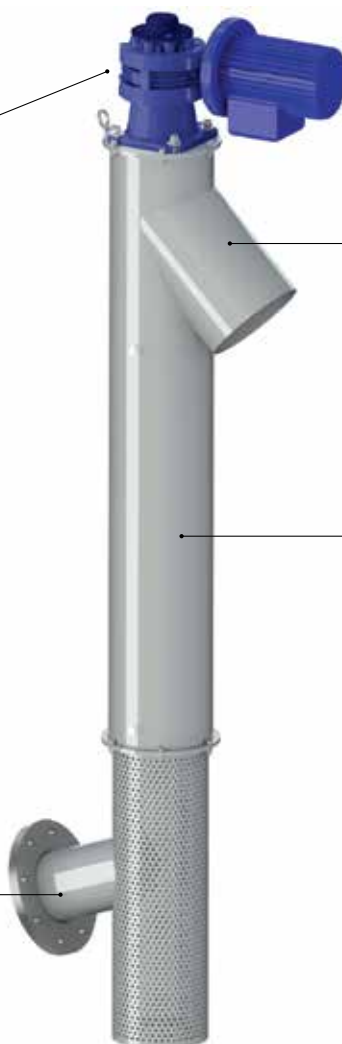

Anti-wear SINT® engineering polymer screw

MODEL	FLOW RATE (2mm) [l/s]	FLOW RATE (5mm) [l/s]	SOLIDS EXTRACTION [dm³/s]
CT / CTC 150	5	10	0.13
CT / CTC 200	7	13	0.16

*Note: Values related to clean water*

## Accessories

- Quick coupling (only for CT)

# Applications



203001332 November 2021 Rights reserved to modify technical specifications.

This brochure has been edited for distribution in European Union countries



**SAVECO™**  
Member of WAMGROUP®



[www.saveco-water.com](http://www.saveco-water.com)